

THE BALTIC SHIPPING COMPANY
5 Mezhevoi Canal, Leningrad, 198035, U.S.S.R.
Cables Morflot/Leningrad. Telephones: 16-90-57, 16-93-23
Telex: 501, 502, 503

General Agents for North America

march shipping passenger services

UNITED STATES

NEW YORK, N.Y. (10048)
ONE WORLD TRADE CENTER

Suite 5257

Cables: Marshipass, New York, Tel. (212) 938-9300

Telex: 23-5758 — TWX: 710: 581-5253

NEW ORLEANS, LA. (70130)

200 Carondelet St., Suite 1013; Tel. (504) 552-5171

CANADA

MONTREAL, QUE. H2Y 1K1

400 St. Antoine Street West,

Cables: Marship, Montreal, Tel. (514) 842-8841

Telex: 05-25246. TWX: 610: 421-4462

TORONTO, ONT. M5J 1J7

159 Bay Street, Suite 816

Cables: Marship, Toronto. Tel. (416) 366-2586

Telex: 022-1696

OFFICES AND PRINCIPAL PASSENGER AGENCIES IN EUROPE

MOSCOW, K-25

—Morpasflot

1/4 Zhdanov Street. Cables: Morpasflot Moscow.

Telex: Moscow 647134

LENINGRAD 190000

—Passenger Agency of The Baltic Shipping Company

35 Herten Street. Telex: 551. Tel. 117776, 123053

BREMEN

—Transocean

Martinistrasse 21

Cables: Transocean. Telex: 024-4362. Tel. 36061

LONDON SW1Y 4NN

CTC Lines

1-3 Lower Regent Street

Telephone 01-930-5833

Cables Morflot London Telex: 917-193

LE HAVRE — 76060

—Paul Perrigault

32 rue de Colmar

P.O. Box 701

Telex: 190485. Tel. 21-22-24

PARIS 75002

—Transtours

49 Avenue de l'Opera

Telex: 23732 Cable: Trastur Tel: 74247-39

SEE YOUR LOCAL TRAVEL AGENT

OP 1156

1977

SAILINGS TO
EUROPE

FROM

**NEW YORK/
MONTREAL**



m.s. Mikhail
Lermontov

m.s. Alexandr
Pushkin



**THE
BALTIC
SHIPPING
COMPANY**





What a unique opportunity!

You will experience the traditional Russian hospitality from the moment you step aboard. You will also quickly learn that your enjoyment is of the utmost importance to our staff - and our cuisine includes continental favorites with a wide selection of specialties and wines from the many republics of the Soviet Union. The well-stocked bars feature Russian Vodkas, Armenian Cognac and, of course, most of your own favorites.

These two modern 20,000 ton cruise liners, accommodating up to 750 passengers each, are fully stabilized and built to the most exacting safety and technical specifications. The **staterooms are spacious, air conditioned (most with an ocean view) and are equipped with private telephone and 3 channel musical programmes.** The ships' facilities include a glass-domed indoor/outdoor heated swimming pool, sauna, 5 bars, 2 nightclubs, duty free gift shops with authentic Russian furs and handicrafts, beauty parlour, barber shop, library, theatre, nursery with trained attendants and a fully equipped hospital.

Shipboard entertainment will be a feature of your trip. Traditional Russian songs and dances by members of the ship's crew provide a memorable part of the after-dinner pleasure and a fine dance orchestra completes the program. These one class cruise vessels give every passenger the advantage of having complete run of the ship which creates a wonderful degree of cruise informality not found on other ships - and there are **two crew members to serve every three passengers.**

Only Baltic Shipping gives you the time and opportunity (and can arrange on board) for **sightseeing at each port.** In Leningrad, as an added convenience the ship can also serve as your hotel during your two or three day visit.

What most will you remember about your voyage? Judging from our passengers' comments, you will undoubtedly recall your trip as one of the most fascinating experiences in your life and you will especially remember the officers and crew who really went out of their way to make your trip so enjoyable.



m.s.
**Mikhail
Lermontov**



m.s.
**Alexandr
Pushkin**

The M.S. Mikhail Lermontov built in 1971 & M.S. Alexandr Pushkin built in 1965 (each 20,000 gross tons) are registered in the U.S.S.R.

1977 TRANS-ATLANTIC SERVICE
(Subject to Change Without Notice)

SUMMER SEASON

Eastbound: June 1 to July 31
Westbound: July 16 to Sept. 15

BASIC SEASON

Eastbound: Jan. 1 to May 31 & Aug. 1 to Dec. 31
Westbound: Jan. 1 to July 15 & Sept. 16 to Dec. 31

EASTBOUND

SHIP	NEW YORK	MONTREAL	LE HAVRE	LONDON	BREMERHAVEN	LENINGRAD
ALEXANDR PUSHKIN	—	Sat. May 21	Sun. May 29	Mon. May 30	Tues. May 31	Sat. June 4
MIKHAIL LERMONTOV	Mon. June 6	—	Tues. June 14	Wed. June 15	Thurs. June 16	Mon. June 20
MIKHAIL LERMONTOV	Thurs. July 7	—	Fri. July 15	Sat. July 16	Sun. July 17	Thurs. July 21
ALEXANDR PUSHKIN	—	Mon. Sept. 12	Tues. Sept. 20	Wed. Sept. 21	Thurs. Sept. 22	* Sun. Sept. 25
MIKHAIL LERMONTOV	Wed. Sept. 21	—	Thurs. Sept. 29	Fri. Sept. 30	Sat. Oct. 1	Wed. Oct. 5
MIKHAIL LERMONTOV	Sat. Oct. 22	—	Sun. Oct. 30	Mon. Oct. 31	Tues. Nov. 1	* Fri. Nov. 4
	Embarkation hours 8:00 AM to 11:00 AM Sailing 11:30 AM	Embarkation hours 8:00 AM to 11:00 AM Sailing 11:30 AM	Arrival 10:00 AM Departure 6:00 PM	Arrival 8:00 AM Departure 3:00 PM	Arrival 3:00 PM Departure 8:00 PM	Arrival 9:00 AM

* Riga, Arrival 10:00 AM

WESTBOUND

SHIP	LENINGRAD	BREMERHAVEN	LONDON	LE HAVRE	NEW YORK	MONTREAL
ALEXANDR PUSHKIN	Fri. May 6	Tues. May 10	Wed. May 11	Thurs. May 12	—	Fri. May 20
MIKHAIL LERMONTOV	Sat. May 21	Wed. May 25	Thurs. May 26	Fri. May 27	Sat. June 4	—
ALEXANDR PUSHKIN	Tues. June 7	Sat. June 11	Sun. June 12	Mon. June 13	—	Tues. June 21
MIKHAIL LERMONTOV	Wed. June 22	Sun. June 26	Mon. June 27	Tues. June 28	Wed. July 6	—
MIKHAIL LERMONTOV	Tues. Sept. 6	Sat. Sept. 10	Sun. Sept. 11	Mon. Sept. 12	Tues. Sept. 20	—
MIKHAIL LERMONTOV	Fri. Oct. 7	Tues. Oct. 11	Wed. Oct. 12	Thurs. Oct. 13	Fri. Oct. 21	—
MONTREAL DEPARTURE	Dep. 10:00 PM	Dep. 2:00 PM	Dep. 8:00 PM	Dep. 5:00 PM	—	Arr. 7:00 AM
NEW YORK DEPARTURE	Dep. 10:00 PM	Dep. 3:00 PM	Dep. 8:00 PM	Dep. 4:00 PM	Arr. 8:00 AM	—

All Times mentioned are Local Times

OneWay Passenger Fares

FROM/TO NEW YORK OR MONTREAL

ALL STATEROOMS ARE FULLY AIR-CONDITIONED ONE CLASS (Per Bed)	LE HAVRE						LONDON						BREMERHAVEN						LENINGRAD					
	SUMMER SEASON			BASIC SEASON			SUMMER SEASON			BASIC SEASON			SUMMER SEASON			BASIC SEASON			SUMMER SEASON			BASIC SEASON		
	ONE WAY	Half-Round Trip		ONE WAY	Half-Round Trip		ONE WAY	Half-Round Trip		ONE WAY	Half-Round Trip		ONE WAY	Half-Round Trip		ONE WAY	Half-Round Trip		ONE WAY	Half-Round Trip		ONE WAY	Half-Round Trip	
		10%	20%		10%	20%		10%	20%		10%	20%		10%	20%		10%	20%		10%	20%		10%	20%
Discount Included		Discount Included		Discount Included		Discount Included		Discount Included		Discount Included		Discount Included		Discount Included		Discount Included		Discount Included		Discount Included		Discount Included		
PAYABLE IN EITHER U.S. OR CANADIAN DOLLARS																								
CATEGORY 1 Outside Deluxe double staterooms with bath, shower and toilet: Boat Deck MIKHAIL LERMONTOV Promenade Deck — ALEXANDR PUSHKIN	875	790	700	805	725	645	880	795	705	810	730	650	905	815	725	830	750	665	1035	935	830	940	850	755
CATEGORY 2 Outside single staterooms with shower and toilet, Boat & Promenade Decks	705	635	565	630	570	505	710	640	570	640	580	515	730	660	585	665	600	535	865	780	695	770	695	620
CATEGORY 3 Outside twin-bedded staterooms with shower and toilet, Boat & Promenade Decks	680	615	545	610	550	490	685	620	550	620	560	500	710	640	570	640	580	515	840	760	675	750	675	600
CATEGORY 4 Outside two-berth staterooms with upper berth and lower bed, with shower and toilet, Boat & Promenade Decks	625	565	500	560	505	450	630	570	505	565	510	455	660	595	530	585	530	470	785	710	630	700	630	560
CATEGORY 5 Outside three-berth staterooms with upper berth, lower bed and sofa-bed with shower and toilet. Promenade Deck (ALEXANDR PUSHKIN ONLY) When sold basis 2 cat. 3 rate to apply ...	505	455	405	440	400	360	510	460	410	435	395	350	540	490	435	455	410	365	660	595	530	570	515	460
CATEGORY 6 Inside three-berth staterooms with upper berth, lower bed, and sofa-bed with shower and toilet, Promenade Deck (ALEXANDR PUSHKIN ONLY) Outside four-berth staterooms with two upper berths and two lower beds with shower and toilet, Promenade Deck (ALEXANDR PUSHKIN ONLY)....	485	440	390	415	375	335	490	445	395	425	385	340	510	460	410	445	400	360	640	580	515	560	505	450
CATEGORY 7 Outside two-berth staterooms with upper berth and lower bed, Main and Second Decks	470	425	380	410	370	330	485	440	390	415	375	335	505	455	405	435	395	350	630	570	505	550	495	440
CATEGORY 8 Outside two-berth staterooms with upper berth and lower bed, Third Deck	455	410	365	390	355	315	465	420	375	405	365	325	490	445	395	425	385	340	620	560	500	540	490	435
CATEGORY 9 Outside four-berth staterooms with two upper berths and two lower beds, Main & Second Decks	435	395	350	370	335	300	445	400	360	375	340	300	465	420	375	405	365	325	600	540	480	510	460	410
CATEGORY 10 Outside four-berth staterooms with two upper berths and two lower beds, Third Deck. Inside four-berth stateroom with two upper berths and two lower beds, Second Deck (A.PUSHKIN ONLY)	425	385	340	355	320	285	430	390	345	365	330	295	445	400	360	390	355	315	585	530	470	495	445	400

Special Fares

ROUND TRIP REDUCTIONS

Providing round trip tickets are purchased prior to outward journey the following reductions will be applicable:

	Both ways by Baltic Shipping Company	One way by Baltic Shipping Company Ship, return by other means
BASIC SEASON	20%	10%
SUMMER SEASON	10%	10%

CHILDREN'S FARES

Under 2 years when accompanied by adult \$50.00.
2 years and under 12 years — one half the adult fare for accommodation occupied.
12 years and over — Full fare for accommodation occupied.

SPECIAL EMIGRANT FARES

Special reductions of 10% off the one way Basic season fares and 15% off the one way Summer season fares, are available for emigrants travelling to the U.S.A. or Canada.

EXCURSION FARES

20% reduction applicable for all passengers from one way fares on all round trip bookings. Maximum stay ashore 35 days excluding arrival and departure days.

GROUP FARES

15% reduction applicable year round on Group Inclusive Tours (G.I.T.), or Party fares for groups of 15 or more adults.

STUDENT FARES

Subject to space being available at sailing, the following fares are applicable between New York/Montreal and

LeHavre	\$280.00	London	\$295.00
Bremerhaven	\$310.00	Leningrad	\$350.00

STUDENTS MUST BE BONIFIDE FULL TIME STUDENTS ATTENDING AN ACCREDITED SCHOOL OR COLLEGE AND MUST PRESENT THEIR INTERNATIONAL STUDENT CARDS FOR STUDENT FARES.

PORT TAXES

	ADULTS	CHILDREN
MONTREAL	\$ 2.50	\$ 1.25 (under 12)
NEW YORK	\$ 4.50	\$ 4.50
LONDON	\$ 9.00	\$ 9.00
LE HAVRE	\$10.00	\$10.00 (over 4 years)
LENINGRAD	\$ 2.00	\$ 1.00 (1-12 years)

STAY-A-BOARD IN LENINGRAD

Passengers wishing to stay on board ship during the stay in Leningrad may do so. Charges will be \$45.00 per person per day which includes cabin, meals on board ship and two Intourist tours daily. **Stay-A-Board charges are payable at time of ticketing.**

Interport Fares 1976

PAYABLE IN EITHER U.S. OR CANADIAN DOLLARS	Leningrad to/from			Bremerhaven to/from		London to/from
	Bremerhaven	London	Le Havre	London	Le Havre	Le Havre
	Each Way	Each Way	Each Way	Each Way	Each Way	Each Way
	\$	\$	\$	\$	\$	\$
CATEGORY 1	355	400	445	155	200	85
CATEGORY 2	240	270	300	105	135	60
CATEGORY 3	205	230	255	90	115	45
CATEGORY 4	185	210	235	80	105	45
CATEGORY 5	165	185	205	75	95	40
CATEGORY 6	155	175	195	70	90	40
CATEGORY 7	150	170	190	65	85	35
CATEGORY 8	145	160	180	65	85	35
CATEGORY 9	135	155	175	60	80	30
CATEGORY 10	130	150	165	60	75	30

m.s. Alexandr Pushkin

1977 SUMMER CRUISES FROM MONTREAL



Preview of

AIR/SEA SPECIAL LOW COST TOURS

21 DAYS \$1,220 INCLUSIVE FROM NEW YORK/MONTREAL

15 DAY CRUISE TO LENINGRAD

calling also in FRANCE, GREAT BRITAIN and GERMANY

6 DAYS IN THE USSR - Leningrad - Kiev - Moscow

- * **Leningrad** - see the world famous Hermitage Museum, the Admiralty, St. Isaacs Cathedral and the magnificent architecture of the City.
- * **Kiev** - the capital of the Ukraine and one of the friendliest cities in the Soviet Union.
- * **Moscow** - visit inside the Kremlin walls, see Red Square with Lenin's Tomb and many world famous museums and art galleries.

RETURN TO NEW YORK/MONTREAL BY IATA AIR LINE.

Many other USSR tours also available to SAMARKAND, TASHKENT, TBILISI, ODESSA and other interesting cities.

TOUR PRICE INCLUDES:

Outside third deck staterooms with lower bed and upper berth, based on double occupancy. Air fare based on one-way Moscow/New York shoulder season fare.

21 DAYS TO FABULOUS GERMANY

11 DAY CRUISE to BREMERHAVEN with calls in FRANCE and GREAT BRITAIN
 10 DAYS IN GERMANY exploring the lovely historical cities of COLOGNE, HEIDELBERG, MUNICH, HAMBURG and many more.
 Sample the unparalleled Rhine and Moselle wines.
 RETURN TO NEW YORK/MONTREAL BY IATA AIR LINE.

CRUISE 1 — 9 DAYS — RATES from \$360 to \$795

Arrival				Departure		
Montreal				Thurs.	June 23	5:00 PM
Saguenay River - Cruising	Fri.	June 24	Noon	Fri.	June 24	4:00 PM
Gaspe	Sat.	June 25	Noon	Sat.	June 25	8:00 PM
St.Pierre/Miq.	Mon.	June 27	7:00 AM	Mon.	June 27	7:00 PM
St.John's, Nfld.	Tue.	June 28	8:00 AM	Tue.	June 28	5:00 PM
Sydney	Wed.	June 29	1:00 PM	Wed.	June 29	10:00 PM
Ile de la Madeleine	Thurs.	June 30	9:00 AM	Thurs.	June 30	5:00 PM
Montreal	Sat.	July 2	8:00 AM			

CRUISE 2 — 7 DAYS — RATES from \$295 to \$650

Montreal				Sat.	July 2	5:00 PM
Saguenay River - Cruising	Sun.	July 3	Noon	Sun.	July 3	4:00 PM
Charlottetown	Tue.	July 5	7:00 AM	Tue.	July 5	5:00 PM
St.Pierre/Miq.	Wed.	July 6	9:00 AM	Wed.	July 6	4:00 PM
Perce Rock - Cruising				Thurs.	July 7	10:30 AM
Gaspe	Thurs.	July 7	Noon	Thurs.	July 7	5:00 PM
Quebec	Fri.	July 8	2:00 PM	Fri.	July 8	9:00 PM
Montreal	Sat.	July 9	7:00 AM			

CRUISE 3 — 7 DAYS — RATES from \$295 to \$650

Montreal				Sat.	July 9	5:00 PM
Saguenay River - Cruising	Sun.	July 10	Noon	Sun.	July 10	4:00 PM
Charlottetown	Tue.	July 12	7:00 AM	Tue.	July 12	5:00 PM
St.Pierre/Miq.	Wed.	July 13	9:00 AM	Wed.	July 13	4:00 PM
Perce Rock - Cruising				Thurs.	July 14	10:30 AM
Gaspe	Thurs.	July 14	Noon	Thurs.	July 14	5:00 PM
Quebec	Fri.	July 15	2:00 PM	Fri.	July 15	9:00 PM
Montreal	Sat.	July 16	7:00 AM			

CRUISE 4 — 14 DAYS — RATES from \$590 to \$1300

Montreal	Sat.	July 16		Sat.	July 16	5:00 PM
Quebec	Sun.	July 17	8:00 AM	Sun.	July 17	5:00 PM
Bagotville	Mon.	July 18	9:00 AM	Mon.	July 18	5:00 PM
Bermuda	Fri.	July 22	9:00 AM	Sun.	July 24	5:00 PM
St.Pierre/Miq.	Wed.	July 27	8:00 AM	Wed.	July 27	5:00 PM
Perce Rock - Cruising				Thu.	July 28	
Montreal	Sat.	July 30	7:00 AM			

CRUISE 5 — 6 DAYS — RATES from \$255 to \$560

Arrival				Departure		
Montreal				Sat.	July 30	5:00 PM
Quebec	Sun.	July 31	8:00 AM	Sun.	July 31	1:00 PM
St.Pierre/Miq.	Tues.	Aug. 2	8:00 AM	Tues.	Aug. 2	5:00 PM
Bagotville	Thurs.	Aug. 4	9:00 AM	Thurs.	Aug. 4	3:00 PM
Montreal	Fri.	Aug. 5	2:00 PM			

CRUISE 6 — 7 DAYS — RATES from \$295 to \$650

Montreal				Sat.	Aug. 6	5:00 PM
Saguenay River - Cruising	Sun.	Aug. 7	Noon	Sun.	Aug. 7	4:00 PM
Charlottetown	Tue.	Aug. 9	7:00 AM	Tue.	Aug. 9	5:00 PM
St.Pierre/Miq.	Wed.	Aug. 10	9:00 AM	Wed.	Aug. 10	4:00 PM
Perce Rock - Cruising				Thurs.	Aug. 11	10:30 AM
Gaspe	Thurs.	Aug. 11	Noon	Thurs.	Aug. 11	5:00 PM
Quebec	Fri.	Aug. 12	2:00 PM	Fri.	Aug. 12	9:00 PM
Montreal	Sat.	Aug. 13	7:00 AM			

CRUISE 7 — 20 DAYS — RATES from \$795 to \$1615

Montreal				Sat.	Aug. 13	5:00 PM
Gaspe	Mon.	Aug. 15	8:00 AM	Mon.	Aug. 15	6:00 PM
Bermuda	Thurs.	Aug. 18	4:00 PM	Fri.	Aug. 19	3:00 PM
Havana	Mon.	Aug. 22	10:00 AM	Wed.	Aug. 24	5:00 PM
Nassau	Thurs.	Aug. 25	4:00 PM	Fri.	Aug. 26	5:00 PM
Sydney	Tue.	Aug. 30	1:00 PM	Tue.	Aug. 30	Midnight
Montreal	Fri.	Sept. 2	8:00 AM			

CRUISE 8 — 7 DAYS — RATES from \$295 to \$650

Montreal				Fri.	Sept. 2	5:00 PM
Saguenay River - Cruising	Sat.	Sept. 3	Noon	Sat.	Sept. 3	4:00 PM
Charlottetown	Mon.	Sept. 5	7:00 AM	Mon.	Sept. 5	5:00 PM
St.Pierre/Miq.	Tue.	Sept. 6	9:00 AM	Tue.	Sept. 6	4:00 PM
Perce Rock - Cruising				Wed.	Sept. 7	10:30 AM
Gaspe	Wed.	Sept. 7	Noon	Wed.	Sept. 7	5:00 PM
Quebec	Thurs.	Sept. 8	2:00 PM	Thurs.	Sept. 8	9:00 PM
Montreal	Fri.	Sept. 9	7:00 AM			

m.s.

Alexandr Pushkin

LOCATION OF DECKS

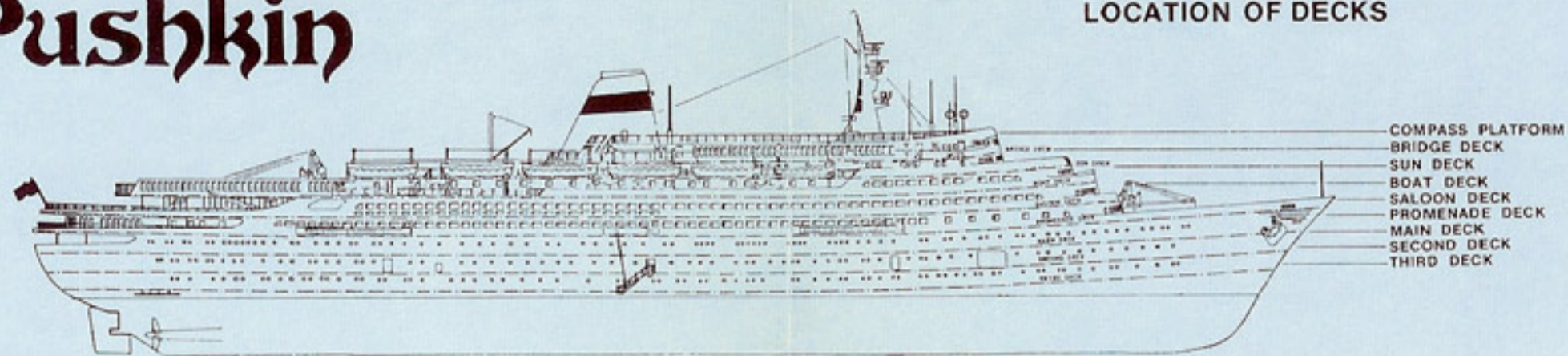

BRIDGE DECK Br

	LOWER BED		EASY-CHAIR
	LOWER BED AND UPPER BERTH		CHAIR
	BABY CRIB		TABLE
	SOFA		WASH-BASIN
	SOFA BED AND UPPER PULLMAN BERTH		BATHING TUB
	WARDROBE		SHOWER
	TWIN-WARDROBE		TOILET
			LIFT

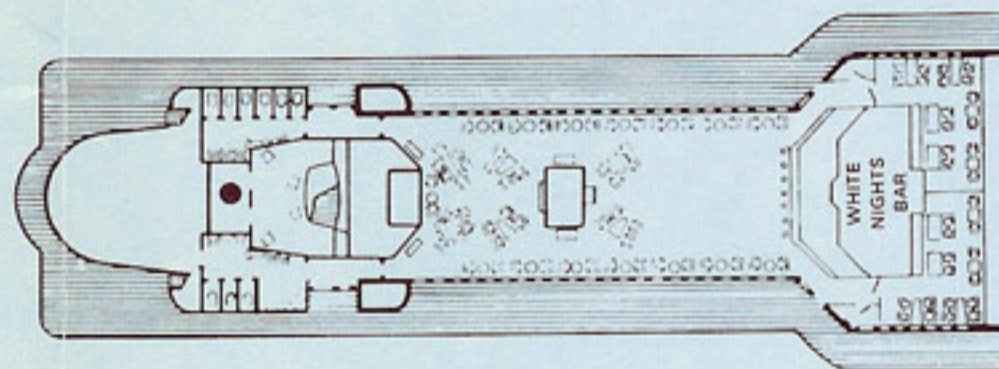

BOAT DECK Bo

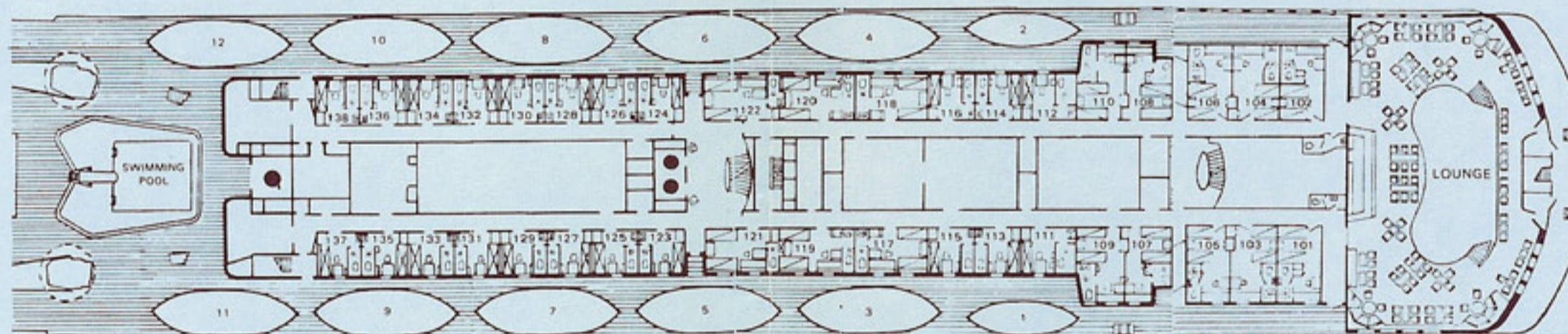

SALOON DECK A

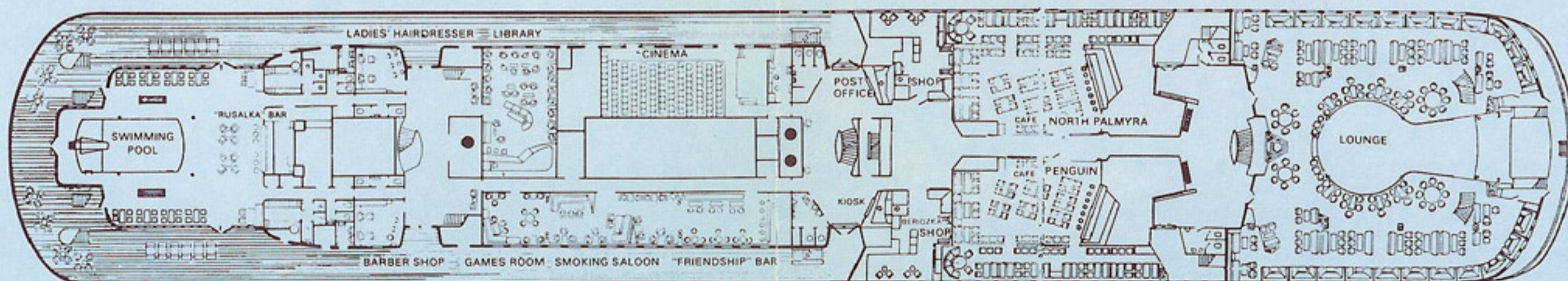

PROMENADE DECK B

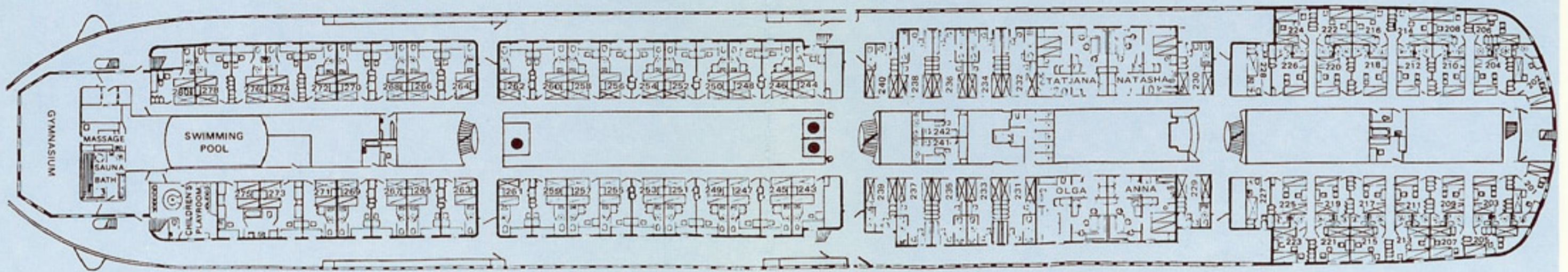

MAIN DECK C

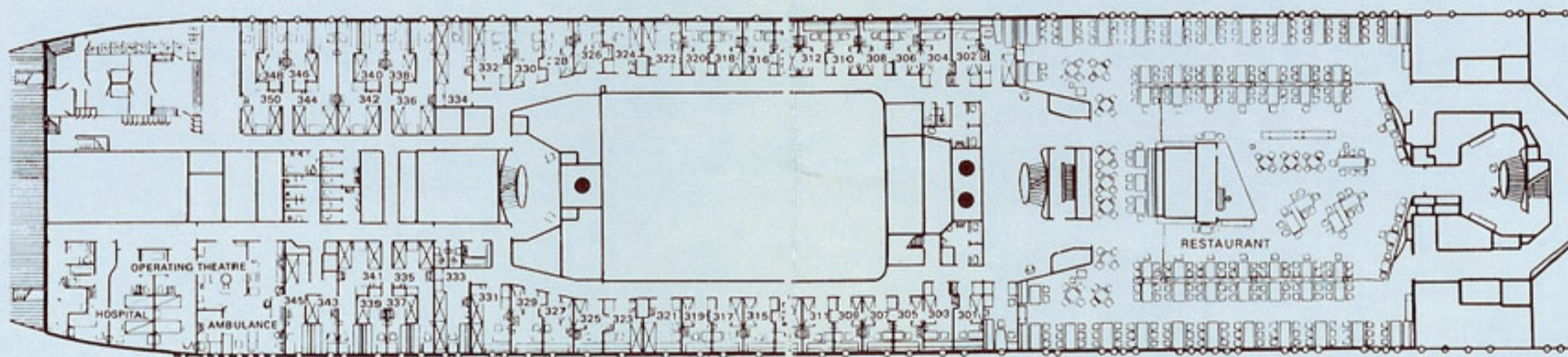

SECOND DECK

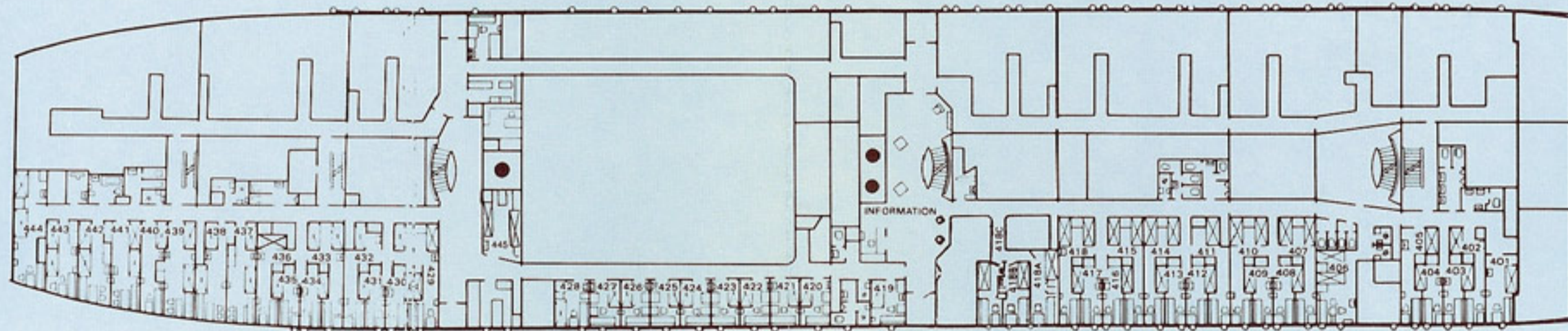

THIRD DECK

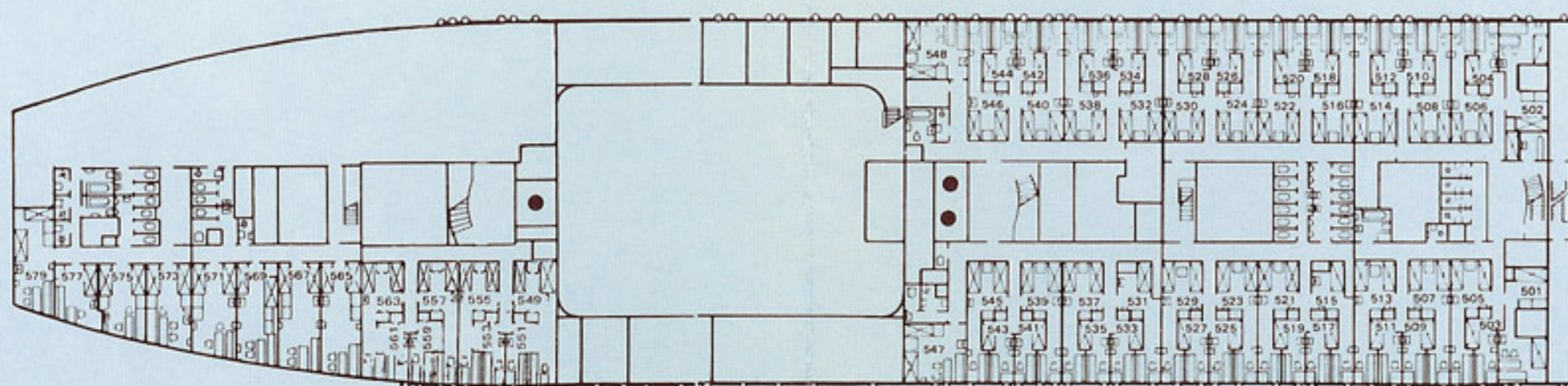

m.s.
**Mikhail
 Lermontov**

LOCATION OF DECKS

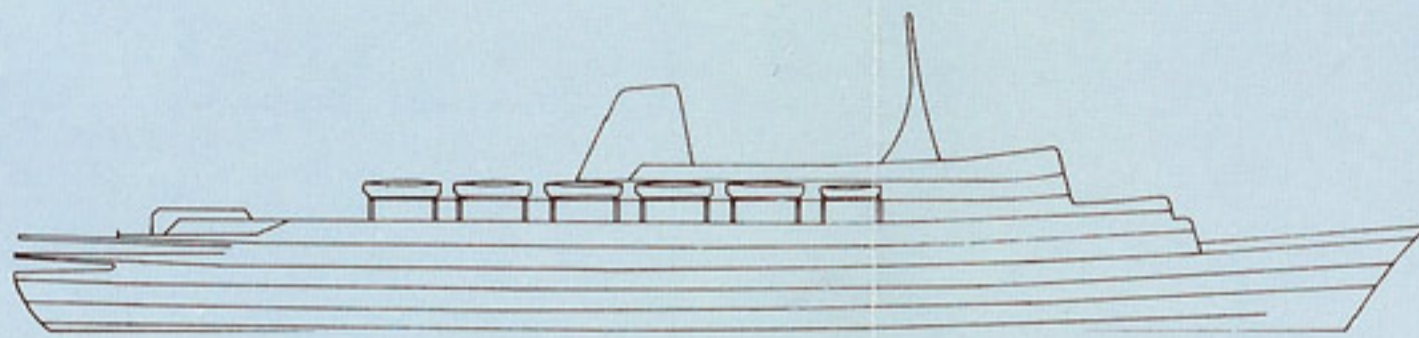

BRIDGE DECK
 SUN DECK
 BOAT DECK
 SALOON DECK
 PROMENADE DECK
 MAIN DECK
 SECOND DECK
 THIRD DECK
 FOURTH DECK

- | | | | |
|--|--------------------------------|--|------------|
| | LOWER BED | | WARDROBE |
| | LOWER BED & UPPER BERTH | | CHAIRS |
| | SOFA BED & UPPER PULLMAN BERTH | | WASH-BASIN |
| | SOFA | | E LIFT |
- KEY TO SYMBOLS**
- | | | | |
|--|--------------------|--|-------------------|
| | B BATH | | TG GENT'S TOILET |
| | T TOILET | | TL LADIES' TOILET |
| | BT BATH & TOILET | | INF INFORMATION |
| | ST SHOWER & TOILET | | IRONING ROOM |
| | S SHOWER | | |

BRIDGE DECK

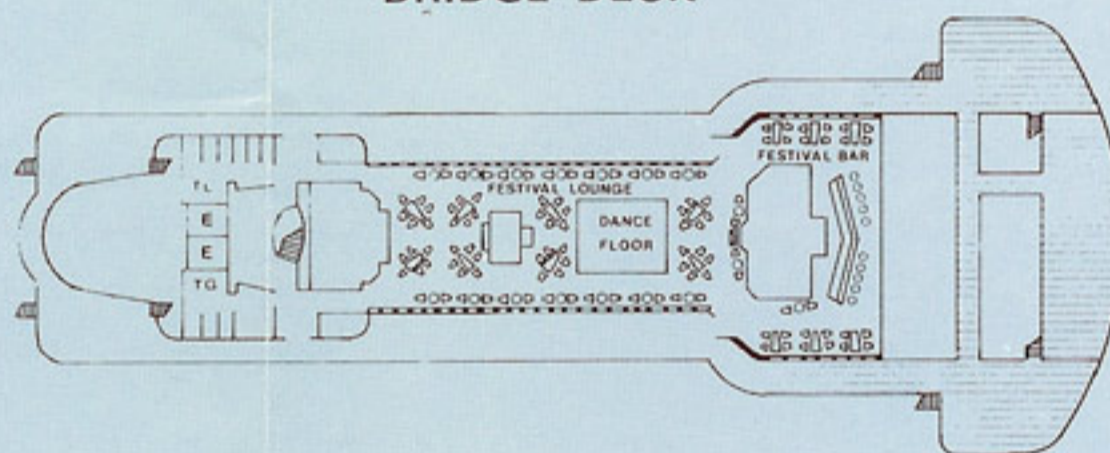

BOAT DECK

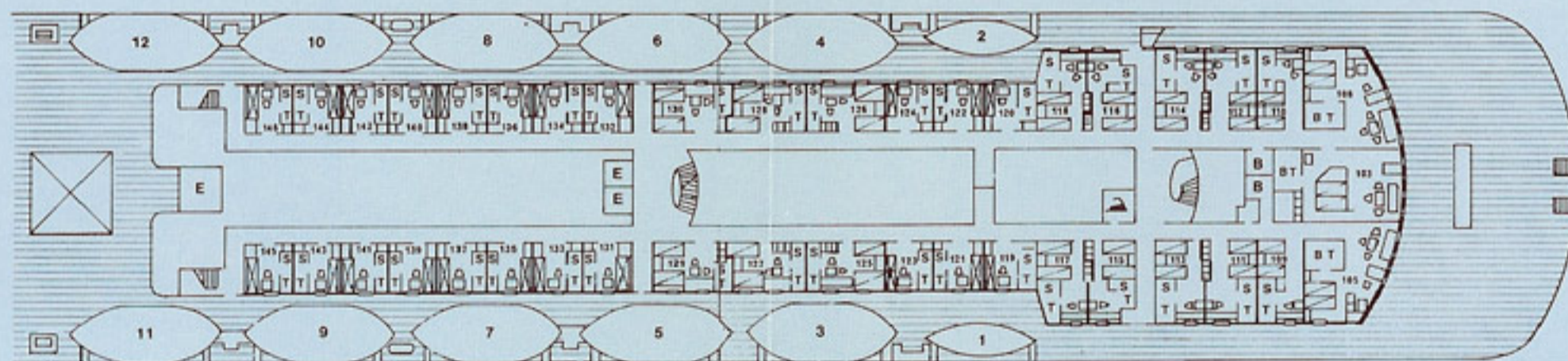

SALOON DECK

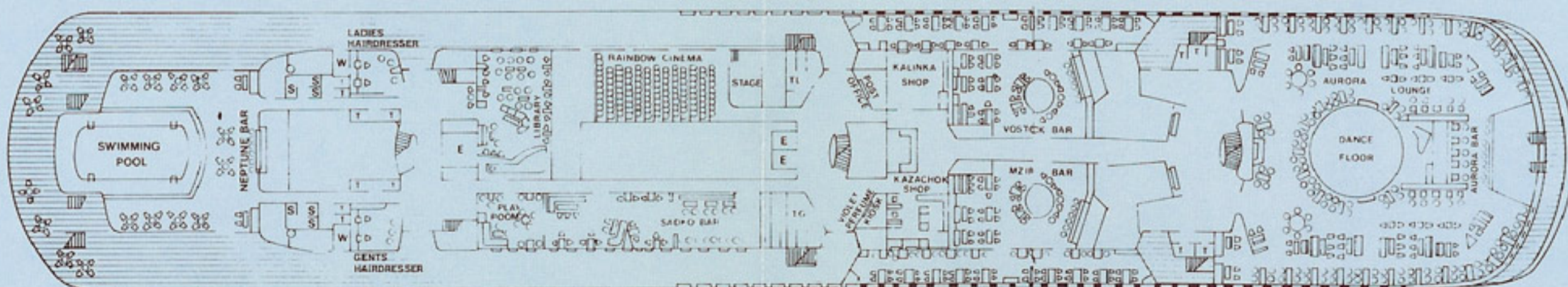

PROMENADE DECK

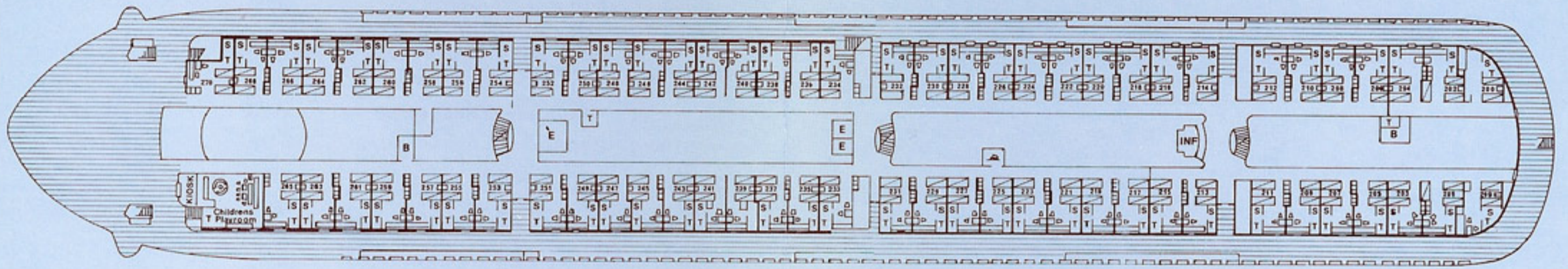

MAIN DECK

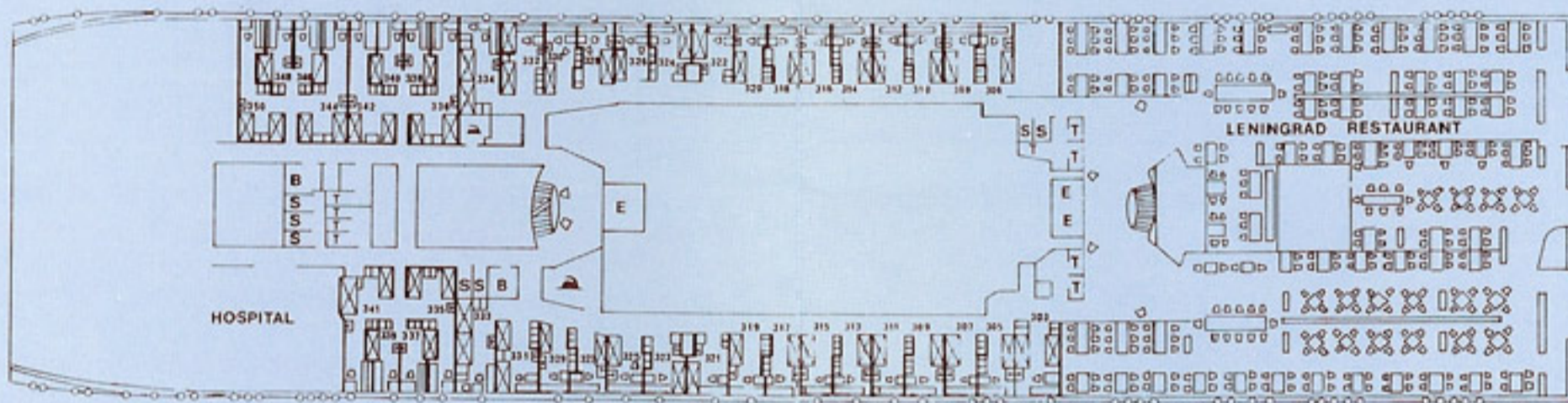

SECOND DECK

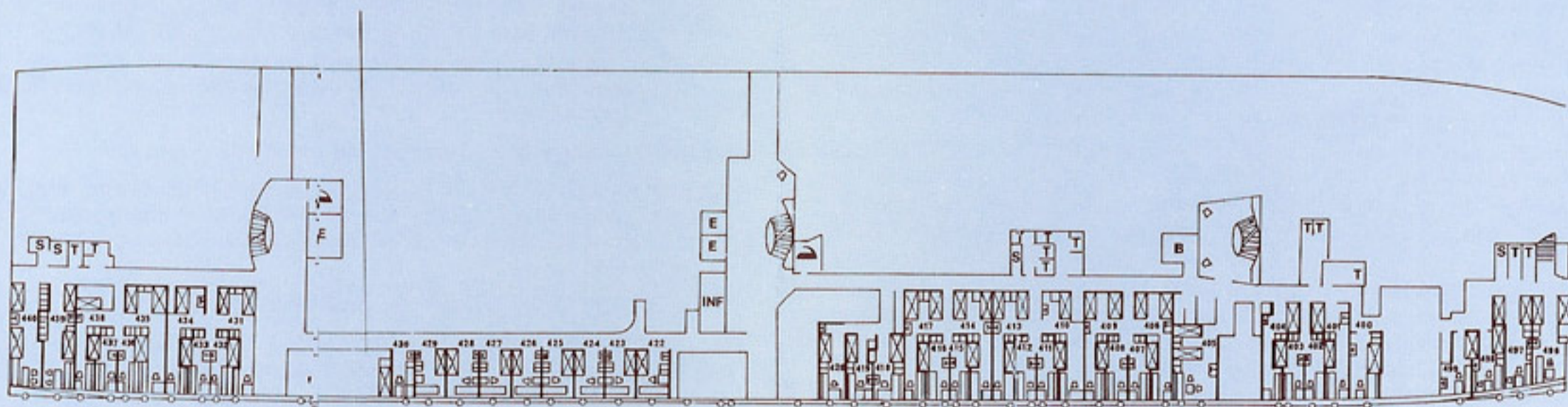

THIRD & FOURTH DECKS

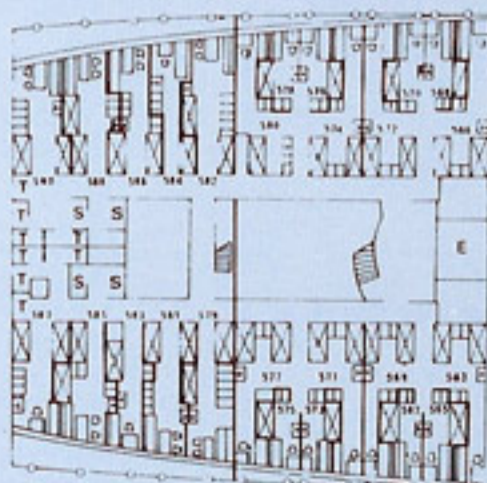

THIRD DECK AFT

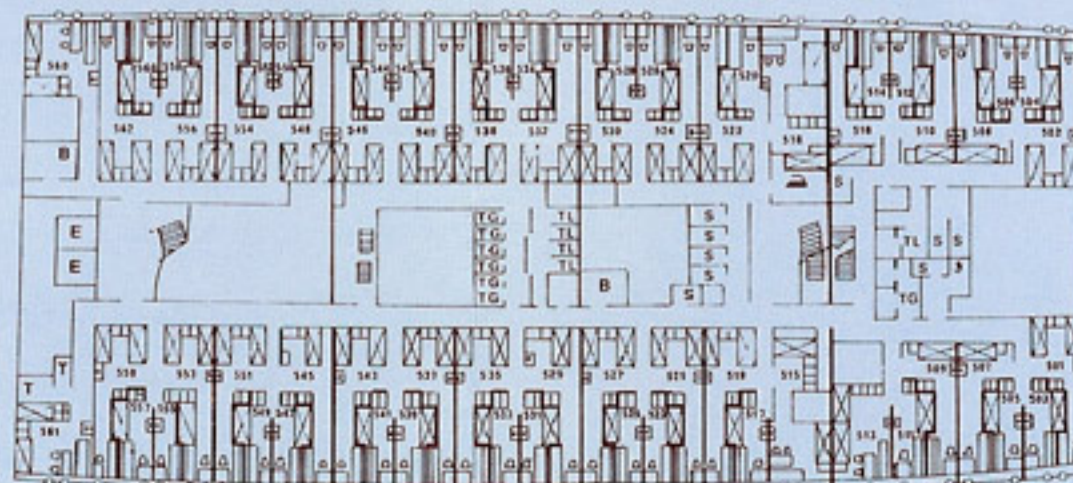

THIRD DECK FORWARD

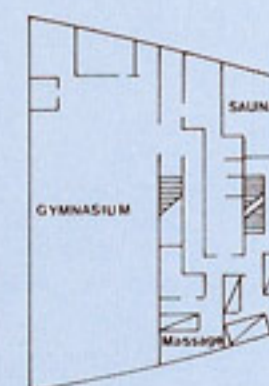

FOURTH DECK