



ms Rotterdam

Deck Plans & Ship Information



Holland America Line

A Signature of Excellence



Luxurious flagship

Our sixth ship to bear the name, the *ms Rotterdam* is the flagship of Holland America's five-star fleet. She offers classic style and premium quality. ~ Elegantly appointed public rooms are graced with fine woods and rich colors, and a full 80 percent of her spacious staterooms offer breathtaking ocean views. ~ A wealth of activities and indulgences on board the *ms Rotterdam* make the experience truly memorable, such as the Culinary Arts Center—presented by *Food & Wine* magazine—and The Greenhouse Spa & Salon, one of the top full-service luxury resort spas in the world. ~ Every voyage aboard this superlative ship is graced with small touches, like an abundance of fresh flowers, and bold strokes, like an extensive collection of fine art, sculptures and antiques from around the world. ~ Set sail for an extraordinary experience, the *ms Rotterdam* offers a once-in-a-lifetime voyage of delight and discovery.



UPPER LEFT: The Queen's Lounge is home to a host of award-winning performances. From Las Vegas-style productions to talented vocalists, illusionists, comedians and variety acts, the *ms Rotterdam* offers the very best in onboard entertainment. You can also experience live music at the Tropic Bar, try your luck at the casino or dance the night away at the Ocean Bar or Crow's Nest.

LOWER LEFT: The reservations-only Pinnacle Grill, renowned for its Sterling Silver Beef and Bvlgari® china, ensures an extraordinary dining experience by providing two servers per table. Holland America Line believes dining is not about quantity, but experience and celebration; we are known far and wide for our innovative culinary concepts and extensive wine list, featuring many selections rated "Excellent" by *Wine Spectator*.

UPPER RIGHT: Take a brisk walk on the teak promenade deck or simply relax with an afternoon cocktail. The ship also has a basketball court and practice tennis court where you can hone your game under the wide-open sky.

MIDDLE RIGHT: The relaxed Lido Restaurant offers a casual alternative for all three meals. Choose from a variety of fresh, cooked-to-order specialties for lunch and dinner, and indulge yourself with a chocolate dessert extravaganza or late-night snack.

BOTTOM RIGHT: At the heart of the *ms Rotterdam*, a specially commissioned signature sculpture is suspended in a soaring, three-story atrium. A fanciful 17th-century Flemish clock tower announces the time in 14 locations around the globe.





Experience heaven on the high seas.

UPPER LEFT: The La Fontaine Dining Room is a two-tiered dining venue that provides one of the finest dining experiences at sea, offering everything from continental cuisine to vegetarian and low-carb options. Five-course menus, created daily and seldom repeated, are enhanced by impeccable service and an extensive wine list. You can also enjoy special Royal Dutch High Tea once per cruise.

UPPER RIGHT: The *ms Rotterdam* features two swimming pools and delightful commissioned sculptures. The aft pool offers fabulous views off the back of the ship, and the Lido Pool is sheltered beneath a retractable glass-domed roof. After a dip in the whirlpool, get a quick bite at the Terrace Grill, where swimsuits are suitable attire.

BOTTOM, LEFT TO RIGHT: The Culinary Arts Center—presented by *Food & Wine* magazine—is a dream come true for food lovers, cooks and epicureans. You'll get a first-hand glimpse of our world-class chefs in action through gourmet demonstrations, tasting events and intimate cooking classes. Overhead mirrors and cameras provide close-ups of the action onto large plasma screens, or you can view live broadcasts in the comfort of your stateroom.

The Explorations Café—powered by *The New York Times*—is a welcoming respite where you can sip a mocha while e-mailing loved ones back home. This elegant, cutting-edge environment offers much more than a comfortable place to enjoy your favorite tunes at a listening station. You can also surf the Internet, work on crossword puzzles and peruse an extensive library.

The Greenhouse Spa & Salon is a sensuous treat for all five senses, offering massage and a wide variety of luxurious treatments, including couple's massage rooms, a dry float suite, thermal steam and aromatic room and relaxation area. You can work out on all the latest exercise and weight-training equipment or take a Pilates class at the Fitness Center. Or you can simply relax on a heated ceramic lounger and enjoy the glorious passing scenery.

The Explorer's Lounge provides a comfortable after-dinner atmosphere for enjoying hand-dipped chocolates and specialty coffee drinks. Live classical music creates a tasteful ambiance while our skilled crew caters to your every preference.



DOLPHIN DECK
Staterooms 1800-1956
90 ft. from bow
to Staterooms 1800 & 1801.

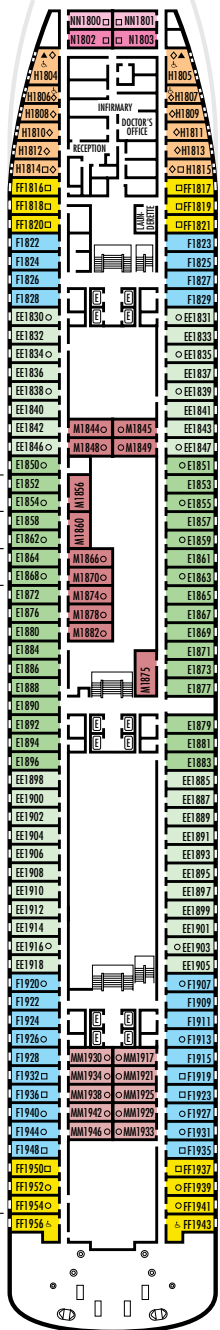

52 ft. to stern
from Staterooms 1943 & 1956.

MAIN DECK
Staterooms 2500-2711
103 ft. from bow
to Staterooms 2500 & 2501.

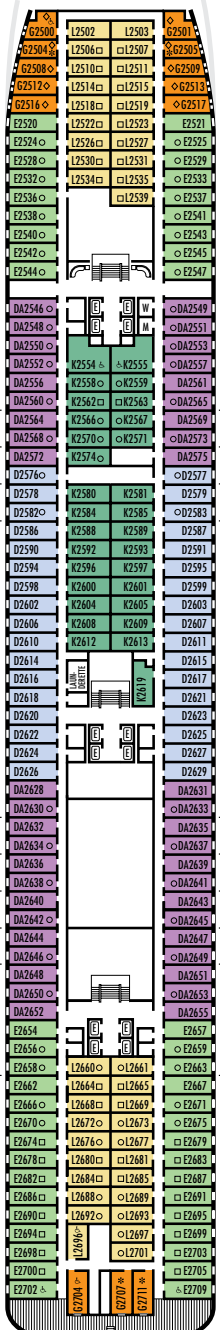

16 ft. to stern
from Staterooms 2704, 2707 & 2711.

LOWER PROMENADE DECK
Staterooms 3300-3431
118 ft. from bow
to Staterooms 3300 & 3301.

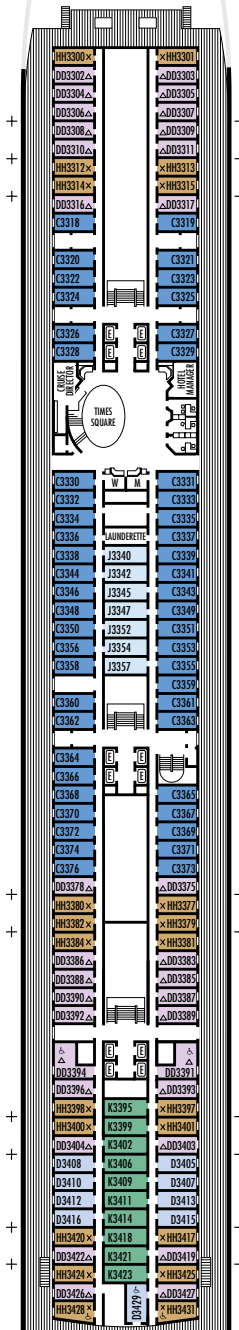

21 ft. to stern
from Staterooms 3428 & 3431.

PROMENADE DECK

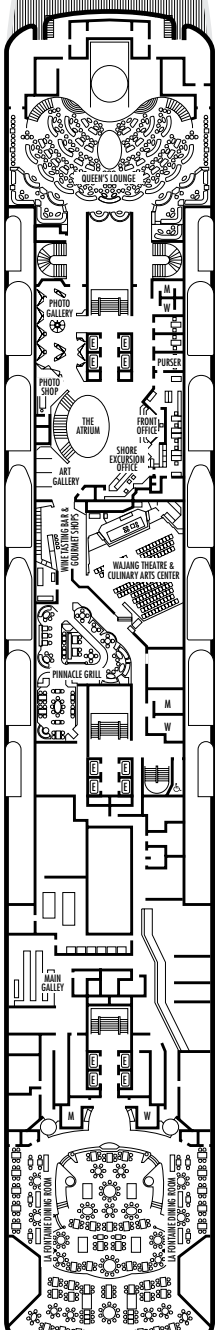

UPPER PROMENADE DECK

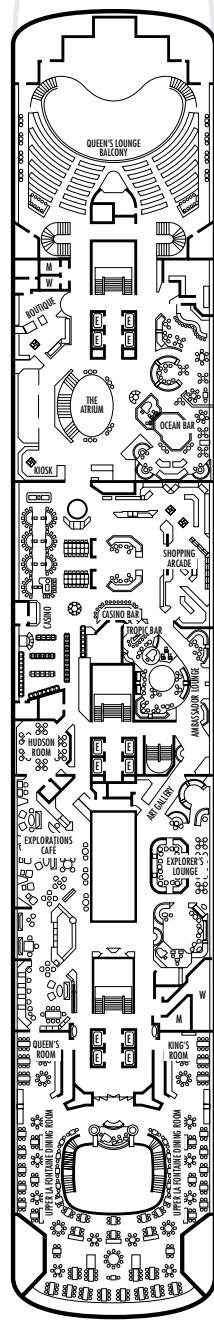

VERANDAH DECK
Staterooms 6100-6228
138 ft. from bow
to Staterooms 6100 & 6102.

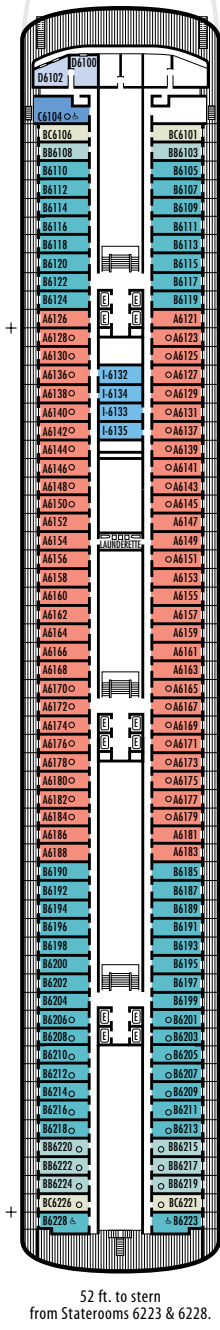

52 ft. to stern
from Staterooms 6223 & 6228.

NAVIGATION DECK
Staterooms 7001-7041
226 ft. from bow
to Staterooms 7001 & 7002.

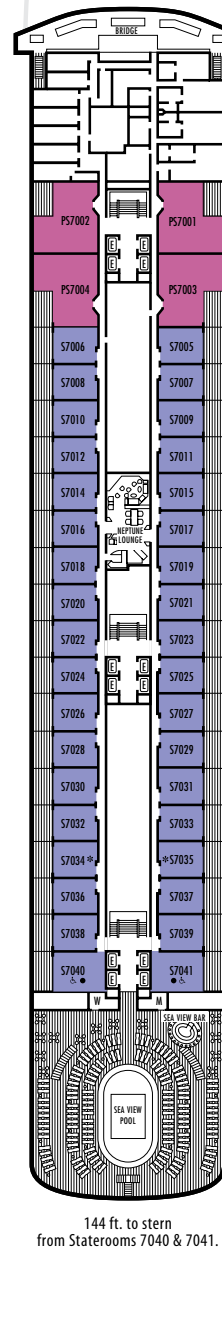

144 ft. to stern
from Staterooms 7040 & 7041.

LIDO DECK

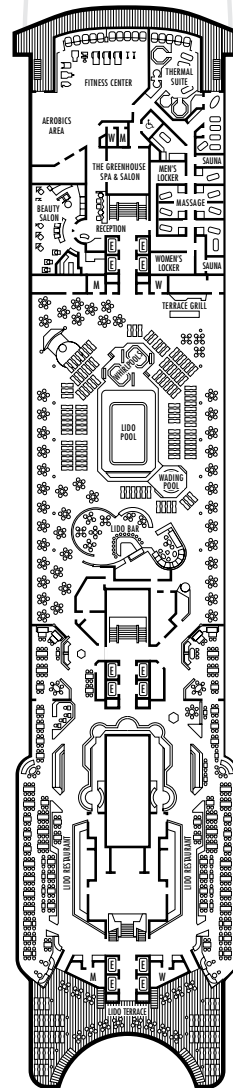

SPORTS DECK

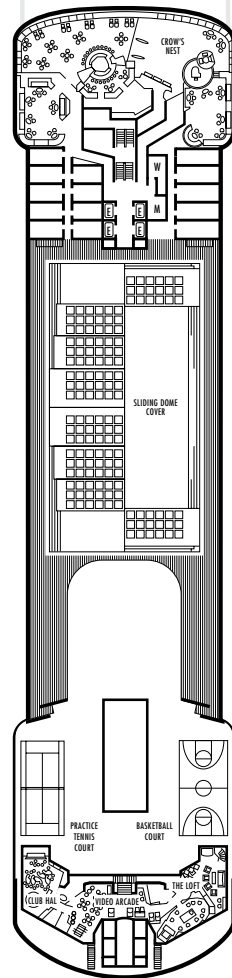

SKY DECK

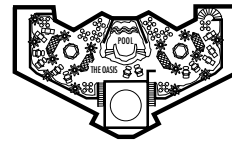

ms Rotterdam

DECK PLANS & STATEROOMS

The deck plans are color-coded by category of stateroom, and the category letter precedes the stateroom number in each room. All staterooms are equipped with DVD player, flat-panel television, telephone and multi-channel music.

Important Note: Not all staterooms within each category have the same furniture configuration and/or facilities. Appropriate symbols within the rooms on the deck plans describe differences from the stateroom descriptions below.

VERANDAH SUITES

PS
Penthouse Verandah Suites: Bedroom with 1 king-size bed, oversize whirlpool bath & shower, living room, dining room, dressing room, private verandah, pantry, 1 sofa bed for 2 persons, mini-bar, refrigerator, guest toilet, floor-to-ceiling windows.

S
Deluxe Verandah Suites: 2 lower beds convertible to 1 king-size bed, whirlpool bath & shower, large sitting area, dressing room, private verandah, 1 sofa bed for 2 persons, mini-bar, refrigerator, floor-to-ceiling windows.

A B BB BC
Verandah Suites: 2 lower beds convertible to 1 queen-size bed, whirlpool bath & shower, sitting area, private verandah, mini-bar, refrigerator, floor-to-ceiling windows.

OCEAN-VIEW STATEROOMS
C D DA DD E EE
F FF G H
Large: 2 lower beds convertible to 1 queen-size bed, bathtub & shower. All DD-category staterooms have partial sea views.

HH
Large: 2 lower beds convertible to 1 queen-size bed, bathtub & shower. All HH-category staterooms have fully obstructed views.

INSIDE STATEROOMS
I J K L M MM
Large: 2 lower beds convertible to 1 queen-size bed, shower.
N NN
Standard: 2 lower beds convertible to 1 queen-size bed, shower.

STATEROOM SYMBOL LEGEND

- * Shower only
- Bathtub & shower
- ▲ 2 lower beds
- Triple (2 lower beds, 1 sofa bed)
- Quad (2 lower beds, 1 sofa bed, 1 upper)
- △ Partial sea view
- ✕ Fully obstructed view
- + Connecting rooms
- ♿ Staterooms S7040 & S7041 are wheelchair accessible, bathtub & shower. Staterooms B6223, B6228, C6104, D3429, DD3391, DD3394, E2702, E2709, FF1943, FF1956, G2500, G2704, H1804, H1805, H1806, H1807, HH3428, HH3431, K2554, K2555, L2696 are wheelchair accessible, shower only.
- ◇ These staterooms have portholes instead of windows

SHIP SPECIFICATIONS & FACILITIES

- 1,316 Guests
- 62,000 Gross Tons
- 778 Feet Long
- Automatic Stabilizers
- 10 Guest Decks
- 12 Guest Elevators
- 18 Public Rooms
- 3 Restaurants
- 2 Outdoor Swimming Pools (one with sliding glass roof)
- Health Spa
- Movie Theatre
- Duty-free Shops
- Internet Center
- Library
- Casino
- Suite Lounge
- Beauty Salon
- Practice Tennis Court
- Basketball Court

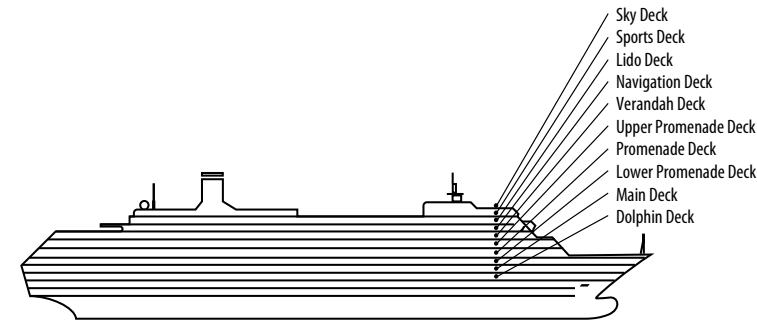

Staterooms with room to move.

Our elegant staterooms are the largest of any premium cruise line. Many of our staterooms feature spacious, private verandahs where you can enjoy complimentary 24-hour alfresco dining, and all staterooms include a flat-panel television, DVD player and ship-to-shore telephone. You'll sleep soundly on a Mariner's Dream™ bed beneath finely woven cotton linens. And each morning you'll discover the daily satellite edition of *The New York Times*, delivered to your stateroom.

For guests staying in the Penthouse Verandah Suites and Deluxe Verandah Suites, the exclusive Neptune Lounge offers a well-stocked library, coffee, tea and snacks, as well as personal concierge service. And all suite guests have access to convenient, one-touch telephone concierge service, 24 hours a day.

SUPERIOR SHIP FACILITIES

In addition to the incredible range of dining choices, entertainment options and activities, the *ms Rotterdam* provides all the facilities you need to make your voyage everything you'd hope for.

ENRICHING ACTIVITIES

With more than 50 scheduled shipboard activities—from kick-boxing to dancing, wine tasting to art auctions—you're free to do as much or as little as you please. The Explorations Speaker Series, on cruises 10 days or longer, gives you an inside look at the history, culture and traditions of the exciting destinations you'll explore. You can even catch a live sports telecast or watch recent-release movies while you munch free popcorn. Kids have all kinds of age-appropriate activities to choose from, so they can enjoy a (supervised) good time. And teens can relax and socialize with new friends at The Oasis or play the latest video games at The Loft, an indoor teens-only space.

EXCURSIONS AND ONBOARD SERVICES

Planning to explore a destination? We recommend you book online before you depart, but you can also contact the onboard Holland America Shore Excursions office to find out about tour options and exclusive Medallion Shore Excursions. You'll enjoy duty-free shopping at the Signature Shops and specialty wine and gourmet shop. There is also a photo center, laundry and dry-cleaning service and self-serve launderettes. And for peace of mind, we offer a U.S.- or Canadian-trained doctor and nursing staff, along with a full range of FDA-approved medications.

MEETING ROOMS OF ALL SIZES

No matter what size gathering you have in mind, Holland America Line will take care of the details. The *ms Rotterdam* offers meeting rooms for everything from small seminars and cocktail parties to large presentations. You'll also have access to a full range of audio-visual equipment to meet your needs.

www.hollandamerica.com

SPACIOUS, ELEGANT SHIPS • GRACIOUS, AWARD-WINNING SERVICE • WORLDWIDE ITINERARIES
EXTENSIVE ACTIVITIES AND ENRICHMENT PROGRAMS • SOPHISTICATED FIVE-STAR DINING

PUBLIC AND MEETING ROOM CAPACITIES

La Fontaine Dining Room	668	Queen's Lounge	555	Meeting Rooms	
Lido Restaurant	385	Crow's Nest	325	Hudson Room	80
Pinnacle Grill	84	Ocean Bar	229	Queen's Room	60–120
Wajang Theater and Culinary Arts Center	129	Explorer's Lounge	113		
Explorations Café	82	Tropic Bar/ Ambassador Lounge	99		

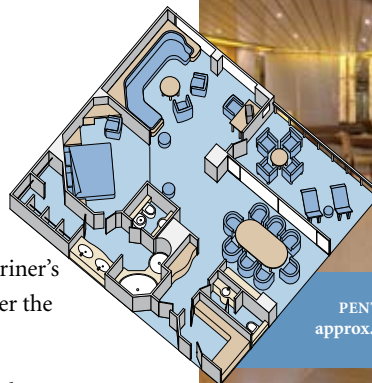

PENTHOUSE VERANDAH SUITE
approx. 1,159 sq. ft. with verandah

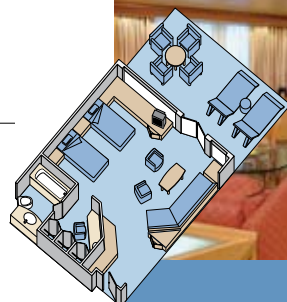

DELUXE VERANDAH SUITE
approx. 556 sq. ft. with verandah

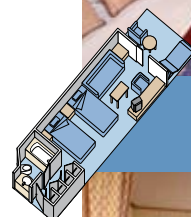

VERANDAH SUITE
approx. 292 sq. ft. with verandah

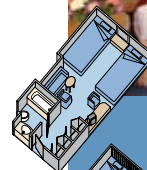

LARGE OUTSIDE DOUBLE
approx. 197 sq. ft.

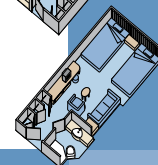

LARGE INSIDE DOUBLE
approx. 182 sq. ft.

NOTE: Room measurements are approximated, and some rooms in the same category may vary in size and/or have different furniture placement from that pictured.

Ship's Registry: The Netherlands

RO16098 Effective September 2007